



PITTSBURGH CORNING GLASS BLOCK PROJECT PLANNER

Timeless Beauty All Around Your Home

- Durable
- Easy to maintain
- Won't scratch or discolor
- Transmits light
- Creates privacy
- Easy to install



Use this grid to lay out your project and determine the materials you will need.

PRESENTED IN 3 EASY STEPS

1 Select the Right Series of Glass Block

Pittsburgh Corning offers two basic series of glass block — *Premiere* and *Thinline™*. Both series are available in assorted patterns and sizes. As well, each series has different types of finishing units available to complement your project. Not all products shown may be in stock. Consult your retailer for availability and pricing of special order items.

NOTE: THIS GUIDE IS ONLY FOR OUR MOST POPULAR PATTERN — DECORA®.

Premiere Series

- 4" thick (nominal) provides extra stability and durability
- Choice of architects and building professionals
- Highest insulation, sound transmission and fire resistance ratings
- Recommended for curved and angled panels, and shower walls
- Suitable for interior walls up to 250 square feet and exterior walls up to 144 square feet
- **Mortar installation only**

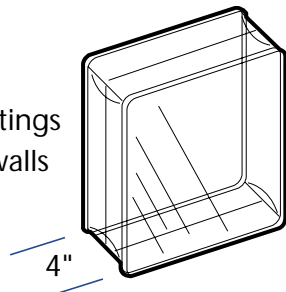

Premiere Series Glass Block

Available in the following sizes (nominal*):
 4" x 8" 8" x 8" (Our most popular block)
 6" x 6" 12" x 12"
 6" x 8"



8" x 8" DECORA® Pattern Block, with distinctive wavy undulations, maximum light transmission and subtle distortion.

Premiere Series Finishing Units

Available in the following sizes and styles:
 (DECORA® pattern only)

EndBlock™, 6" x 8" and 8" x 8"
 For finishing horizontal or vertical edges of interior panels.

ENCURVE® 8" Blocks
 With arched, soft edges to round out your design options or finish panels. Use with 8" x 8" EndBlock™ Finishing Units for a stepped panel.

HEDRON® Corner Blocks, 8" high
 Hexagonal corner units allow you to form 90° corners, resulting in a gently rounded continuous glass face. The blocks can be used in combination with any other finishing units.

TRIDRON 45° Blocks®, 8" High
 Create angles or configurations from 45°–360° for columns, alcoves, and undulating panels.

ARQUE® Blocks, 8" High
 Radius design allows for construction of smooth, tightly curved walls with consistent mortar joints.

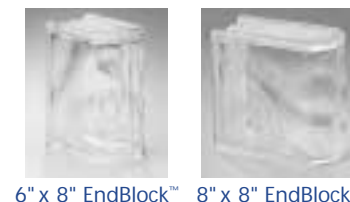

6" x 8" EndBlock™ 8" x 8" EndBlock™

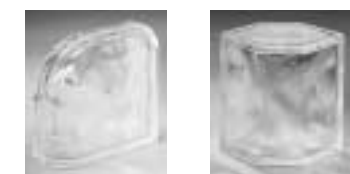

ENCURVE® HEDRON®



TRIDRON 45° Block® ARQUE®

Thinline™ Series

- 3" thick (nominal)
- Popular residential series
- Economical
- Ideal for windows and non-curved walls
- **Silicone or mortar installation**



Thinline™ Series Glass Block

Available in the following sizes (nominal*):

4" x 8" 6" x 8"
 6" x 6" 8" x 8"



8" x 8" Thinline™ DECORA® Pattern Block, with distinctive wavy undulations, maximum light transmission and subtle distortion.

Thinline™ Series Finishing Units

EndBlock™, 4" x 8"
 For finishing horizontal or vertical edges of interior panels.
 (DECORA® pattern only)



EndBlock™

2 Choose the Right Installation System

Mortar Installation

- Use with *Premiere Series* (4" thick) and *Thinline™ Series* (3" thick) Glass Blocks.
- Suitable for interior and exterior applications.
- Use to achieve traditional "grid look" versus the "seamless all-glass look" of silicone installation.
- Use for curved wall (*Premiere Series* only) and straight wall installations.



Silicone Installation

- Use with *Thinline™ Series* (3" thick) Glass Block only.
- No special skills or tools required.
- Interior and exterior applications.
- Use for interior panels no larger than 85 sq. ft. that are framed on all 4 sides. Three-sided support is only recommended where the free edge does not exceed six feet in length. Exterior panels must be no larger than 25 sq. ft. and framed on all four sides.
- Not for use with curved or angled walls.
- Achieve a "seamless all-glass look" versus the mortar traditional "grid look".



* NOTE ON BLOCK SIZE: Actual size is slightly smaller, to allow for application of mortar or silicone. Example: 8" x 8" nominal = 7¾" x 7¼" actual

See reverse side for additional information.

3

Create Your Materials List

It is always easier to cut a rough opening to fit the glass block rather than trying to make the glass block fit a given space. If the space is too large, you need to fill the opening to fit your glass block project.

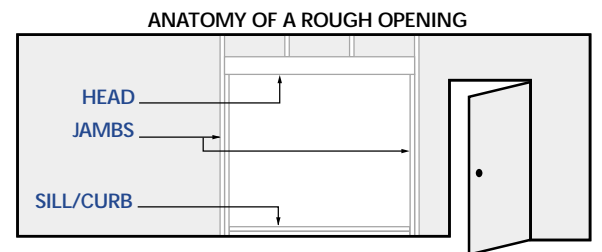

Rough Opening Calculations

Mortar I System

Add 1/8" to sum of the nominal block sizes for both height and width.

Example: Panel (using 8" x 8" block) is four block wide and five block high. Rough opening needs to be 32 1/4" wide and 40 1/4" high.

Mortar II System

Add 1/2" to sum of the nominal block sizes for both height and width.

KWIK'N EZ® Rigid Track Silicone System

Use table shown at right to calculate rough opening when using Rigid Track.

KWIK'N EZ® RIGID TRACK SILICONE SYSTEM ROUGH OPENING TABLE						
Number of Blocks	Rough Opening Size (Inches)					
	Rough Opening Width			Rough Opening Height		
	4" Wide Block	6" Wide Block	8" Wide Block	4" High Block	6" High Block	8" High Block
1	4 1/8	6 1/8	8 1/8	4 1/8	6 1/8	8 1/8
2	8	12	16	8 1/4	12 1/4	16 1/4
3	11 1/8	17 1/8	23 1/8	12 1/8	18 1/8	24 1/8
4	15 1/4	23 1/4	31 1/4	16	24	31 1/4
5	19 1/8	29 1/8	39 1/8	19 1/8	29 1/8	39 1/8
6	23 1/2	35 1/2	47 1/2	23 1/2	35 1/2	47 1/2
7	27 1/4	41 1/4	55 1/4	27 1/4	41 1/4	55 1/4
8	31 1/4	47 1/4	63 1/4	31 1/2	47 1/2	63 1/2
9	35 1/8	53 1/8	71 1/8	35 1/8	53 1/8	71 1/8
10	39	59	79	39 1/4	59 1/4	79 1/4
11	42 1/8	64 1/8	86 1/8	43 1/8	65 1/8	87 1/8
12	46 1/4	70 1/4	94 1/4	47	71	94 1/4

Note: Blocks are available in 4" x 8", 6" x 6", 6" x 8", and 8" x 8" sizes

Mortar I System

For panels 25 sq. ft. or less, enclosed on all four sides

Number of Glass Block – Divide the height and width by the nominal dimension of the glass block you are using.

Example: Using 8" x 8" glass block with a panel height of 48" and a width of 32"

Height = 48" ÷ 8" = 6 block

Width = 32" ÷ 8" = 4 block

Multiply the number of block needed for the height by the number of block needed for the width.

6 block x 4 block = 24 block

Expansion Strip – You will need enough to cover the head (top of panel). Expansion strip is available in 2' lengths.

VeriTru® Spacers – Number of glass block x 1.5.

Example: 24 block x 1.5 = 36 spacers

Perimeter Channels – Channels must be applied on all four sides of the opening and are available in 48" lengths.

Example:

48" + 48" + 32" + 32" = 160 total inches

160" ÷ 48" = 3.3 or 4 channels

Mortar

The following is an estimate of the number of block that can be installed per 50 pound bag of mortar:

Block Sizes (Nominal)	4"x8"	6"x6"	6"x8"	8"x 8"	12"x12"
No. of <i>Premiere Series (4")</i> *	34	34	30	26	18
No. of <i>Thinline™ Series (3")</i> *	42	42	36	32	N/A

*Based on a 1/4" exposed mortar joint.

Note: For exterior applications, 1 tube of Pittsburgh Corning Glass Block Sealant for every 30 lineal feet of perimeter should be used to seal panel at jambs and head.

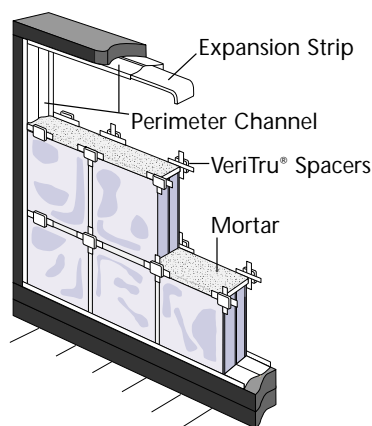

Mortar Installation Accessories

- VeriTru® Spacers**
Speed construction and assure uniform spacing
- Perimeter Channels**
Rigid edge channels for smaller installations
- Panel Reinforcing**
Embedded in mortar between courses for added stability
- Panel Anchors**
Tie glass block panels into surrounding framework when perimeter channels are not used
- Expansion Strips**
Cushion glass block and allow for expansion and construction
- Pittsburgh Corning Glass Block Sealant**
Used for exterior applications to seal perimeter

Tools for Mortar Installation

- Margin Trowel
- Measuring Tape
- Mortar Mixing Pan
- Polyfoam Brush (2)
- Sponge
- Metal File
- 3/8"-1/2" Joint Striking Tool
- Wire Cutters
- Utility Knife
- Tin Snips
- Screwdriver
- 2' Level
- Caulking Gun (Exterior Panels)

Mortar Installation Instructions

Detailed installation instructions are found in every bag of VeriTru® Spacers. Or visit our website: www.pittsburghcorning.com



NO REPRESENTATION OR WARRANTY, EXPRESSED OR IMPLIED AS TO MERCHANTABILITY OR FITNESS FOR A PARTICULAR PURPOSE, is made as to the performance or results of an installation containing the products which extends beyond the description above. All trademarks are the property of Pittsburgh Corning Corporation ©2000 Pittsburgh Corning Corporation GBPP-00

Mortar II System

For panels larger than 25 sq. ft. or enclosed on *only* three sides

Number of Glass Block – Divide the height and width by the nominal dimension of the glass block you are using.

Example: Using 8" x 8" glass block with a panel height of 80" and a panel width of 64"

Height = 80" ÷ 8" = 10 block

Width = 64" ÷ 8" = 8 block

Multiply the number of block needed for the height by the number of block needed for the width.

10 block x 8 block = 80 block

VeriTru® Spacers – Number of glass block x 1.5.

Example: 80 block x 1.5 = 120 spacers

Expansion Strip – You need enough to cover both jambs and the head. Expansion strips are available in 2' lengths.

Panel Reinforcing – Used for the entire width of your opening in every other horizontal mortar joint. Panel reinforcing is available in 48" lengths.

Example:

10 block high = 5 rows of panel reinforcing

5 rows x 64" wide = 320"

320" ÷ 48" = 6.6 or 7 pieces of panel reinforcing

Panel Anchors – Installed every other course along the jambs and the head. Each anchor strip can be cut in half to create two 12" anchors.

Example:

Jamb is 10 block high = 5 anchors per each jamb

Head is 8 block wide = 4 anchors

5 + 5 + 4 = 14 anchors (12") = 7 total anchor strips

Mortar – Please refer to the mortar table above left.

Note: All examples are based on panels with 4-sided support. Adjust requirements for interior panels with 3-sided support.

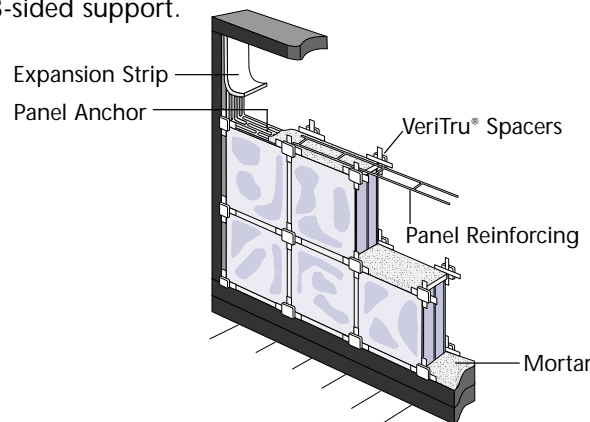

KWIK'N EZ® Rigid Track Silicone System

Number of Glass Block – Divide the height and width by the nominal dimensions of the glass block you are using.

Example: Using 8" x 8" glass block with a panel height of 80" and a panel width of 64"

Height 80" ÷ 8" = 10 block

Width 64" ÷ 8" = 8 block

Multiply the number of block needed for the height by the number of block needed for the width. 10 block x 8 block = 80 block

KWIK'N EZ® Rigid Track Silicone System Kits

One kit will install 16 – 8" x 8" x 3" glass block.

For use with other size block, we recommend purchasing the KWIK'N EZ® Rigid Track in bulk and cutting to accommodate your block size. To determine the amount of Rigid Track you will need, calculate the total joint lineal feet in your project.

Pittsburgh Corning Glass Block Sealant – One tube comes in every KWIK'N EZ® Kit. Purchase one extra tube of sealant for every 30 lineal feet when sealing perimeter.

Perimeter Channels – Channels must be applied on at least three sides of the opening and are available in 48" lengths.

Example:

80" + 80" + 64" + 64" = 288"

288" ÷ 48" = 4.75 or 5 channels

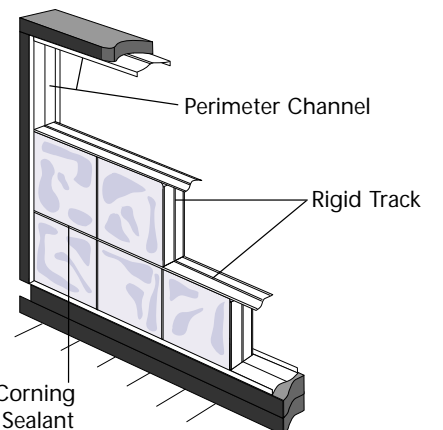

Silicone Installation Accessories

- Pittsburgh Corning Glass Block Sealant**
Joins and seals adjacent glass block; seals perimeter
- KWIK'N EZ® Rigid Track Silicone System Kits**
• Installation Instructions
• 1 Tube Pittsburgh Corning Sealant
- 1 Striking Tool
• 3 – 32" Pieces Rigid Track Spacer
• 12 – 7.72" Coped Pieces Rigid Track
- Perimeter Channel**
Frames and contains glass block panel

Tools for Silicone Installation

- Power Drill
- Screwdriver
- Utility Knife
- Caulk Gun
- Rubber Mallet
- 2' Level
- Tape Measure
- Fine Tooth Saw

Silicone Installation Instructions

Detailed installation instructions are found in every KWIK'N EZ® Kit. Or visit our website: www.pittsburghcorning.com

NEED HELP?

Visit our website:

www.pittsburghcorning.com for ideas, detailed instructions and answers to frequently asked questions.

Or call 1-800-624-2120 to order:

- Installation Video (\$10.95)
- *Touch of Glass* idea book (\$3.95)

YOUR SHOPPING LIST

_____ Glass Block _____:	Quantity _____
Size _____ <small>Premiere or Thinline™</small>	
Finishing Units _____	_____
For Mortar Installation	
Expansion Strips:	_____ pcs.
Panel Anchors:	_____ pcs.
Panel Anchor Screws <small>(#12 x 1" zinc-plated, panhead; 4 per Panel Anchor).</small>	_____
Panel Reinforcing:	_____ pcs.
VeriTru® Spacers <small>(Premiere/Thinline™):</small>	_____ bags
Mortar (50lbs.):	_____ bags
Perimeter Channels <small>(Premiere/Thinline™):</small>	_____ pcs.
Perimeter Channel Screws <small>(#6 x 1" zinc-plated, flathead; 3 per lineal foot).</small>	_____
For Silicone Installation	
KWIK'N EZ® Rigid Track Kits:	_____
Perimeter Channels <small>(Thinline™):</small>	_____ pcs.
Perimeter Channel Screws <small>(#6 x 1" zinc-plated, flathead; 3 per lineal foot).</small>	_____
Extra Glass Block Sealant	_____ tubes